

CMI-VGA02

CMI Module with 1x VGA Port

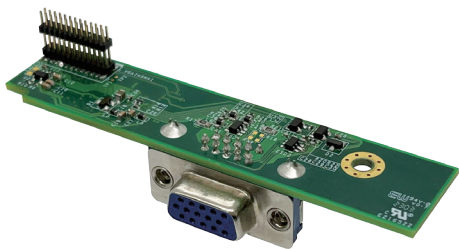

- CMI (Combined Multiple I/O) Technology
- Support Full HD resolution
- Rugged Design Features: Cableless



Specifications

Interface	• CMI (Combined Multiple I/O) Interface
Display Output	• 1x VGA Connector
Max. Resolution	• 1920 x 1200 @60Hz
Dimension (W x D x H)	• 88.63 x 20 x 24.6 mm

Dimensions

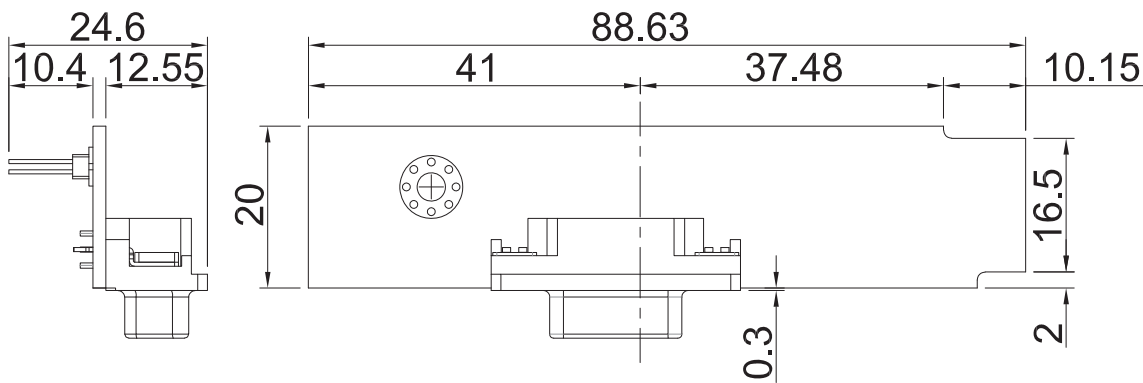

Unit: mm

Ordering Information

Available Models

Model No.	Description
CMI-VGA02-R10	CMI Module with 1x VGA Port

Package Checklist

- CMI Module x1
- Screw Pack x1

Compatible List

Model No.	Product Model
DI Series	DI-1200